

Hands-Free Door Opener

Assembly Instructions

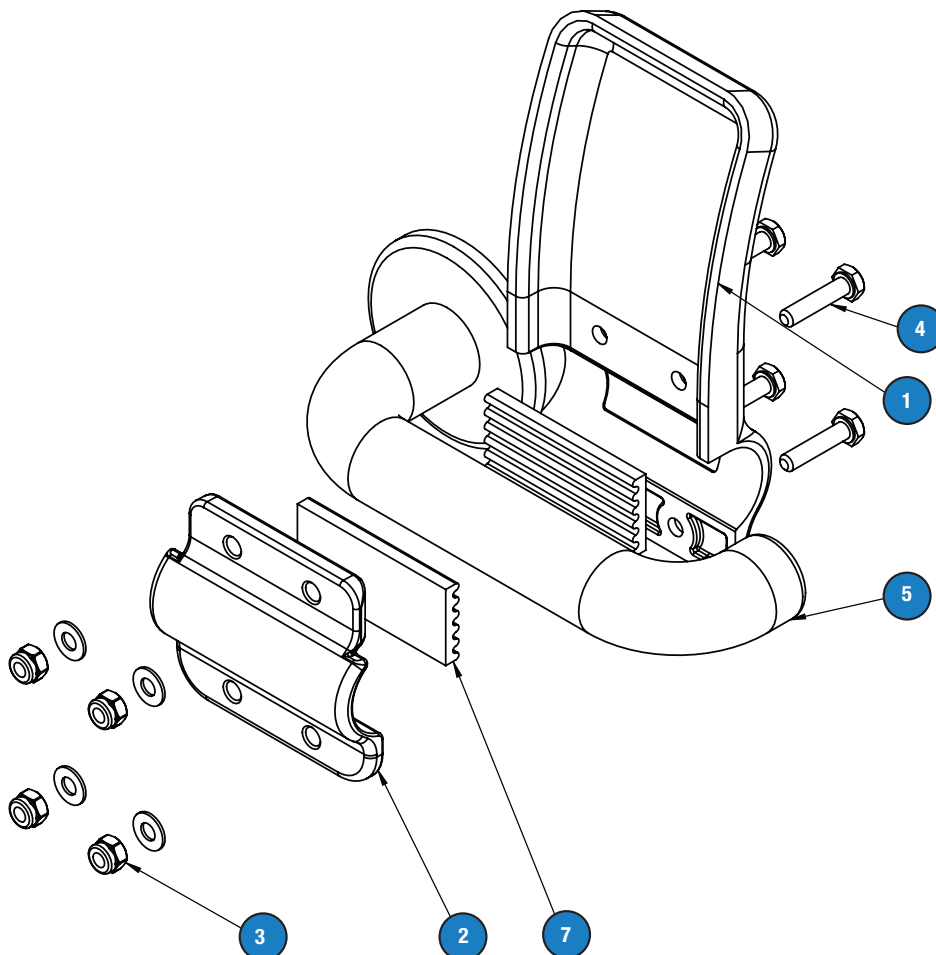

Assembly Instructions

Elements necessary for the assembly: Flat or socket wrench 7 mm

1. Clean and degrease the handle **5**
2. On the inside surface of the parts **1** and **2** and self-adhesive pad **7**
3. Place the door opener on the handle **1** with the front plate facing you
4. Mount the door opener **2** on the handle **5**
5. Pre-tighten the door opener with the screws **3** **4** available in the set
6. Set the position of the door opener against the door (so that the forearm can be freely inserted into the space between the handle and the door)
7. Tighten the screws until the door-opener is fixed

Art. Nr.
RND 600-00250